

H599 - PTZ Camera Mount

Universal Wall Mount for Pan Tilt Zoom Cameras

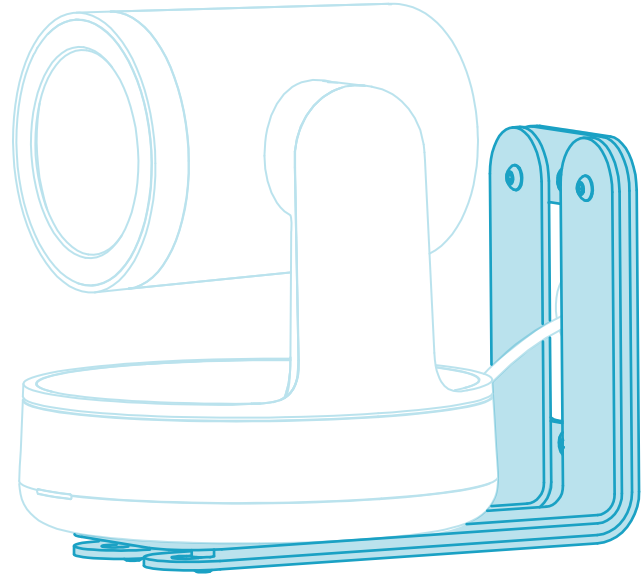

Designed & made in Arizona

Patented

IN THE BOX

- A** 1 x PTZ Camera Mount
- B** 2 x Wall Anchor
- C** 2 x 1/4-20 Camera-mounting screw
- D** 1 x Wall-mounting Screw
- E** 1 x Camera-mounting Hex Key
- F** 1 x Assembly Hex Key
- G** 1 x Cable Tie

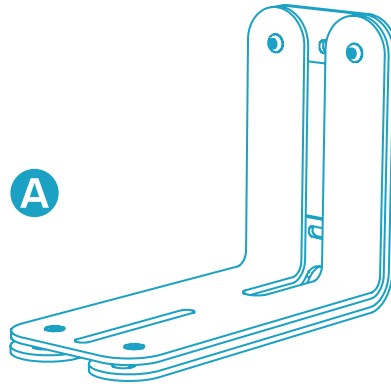

B



C



D



E



F



G



TOOLS NEEDED



Tape Measure



Pen



Power Drill



Phillips Bit



3/4" Drill Bit



Level

COMPONENTS NEEDED (Not Included)

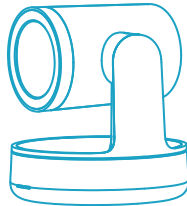

PTZ Camera

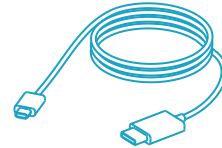

PTZ Power and Data Cables

If you have any questions, please contact
service@hecklerdesign.com.

STEP 1

Disassemble PTZ Camera Mount.



Loosen the screws and slide the upper bracket out through the keyholes.

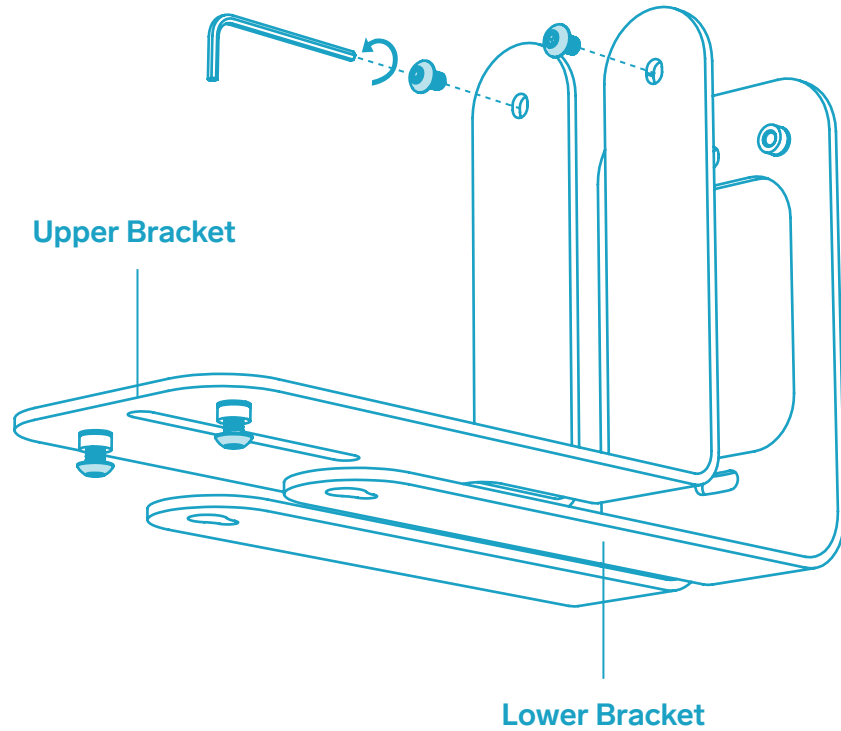

STEP 2

Select mounting location.

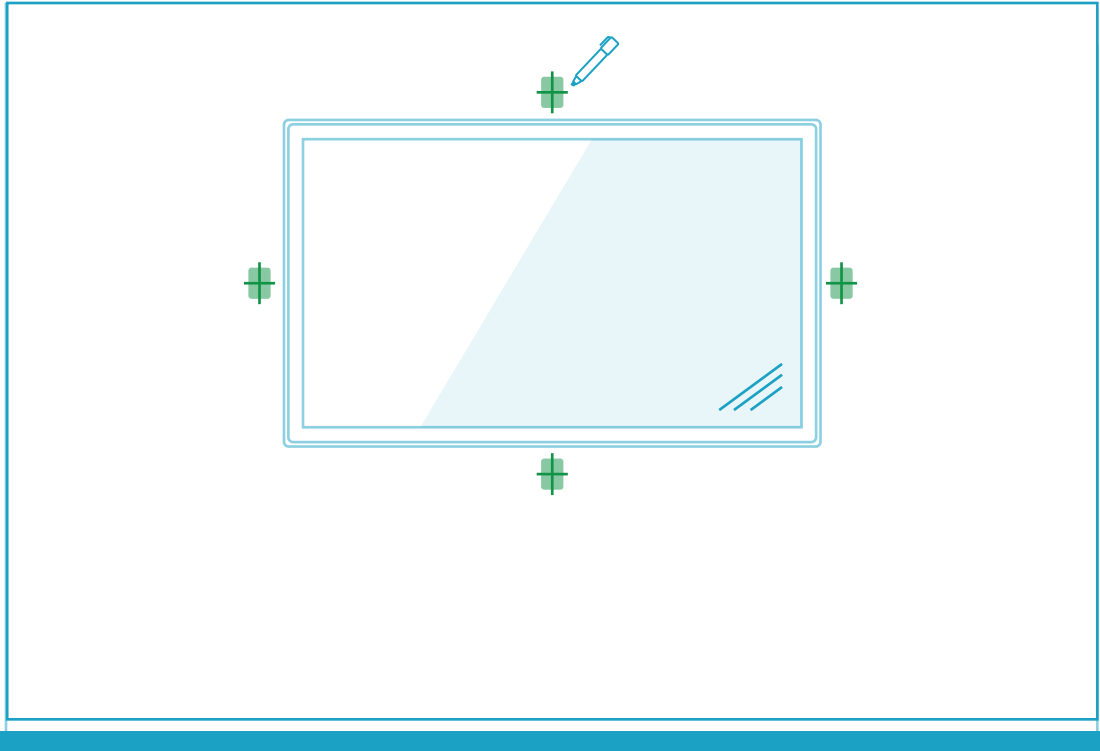

STEP 3

Mounting options.

A Wall Anchor

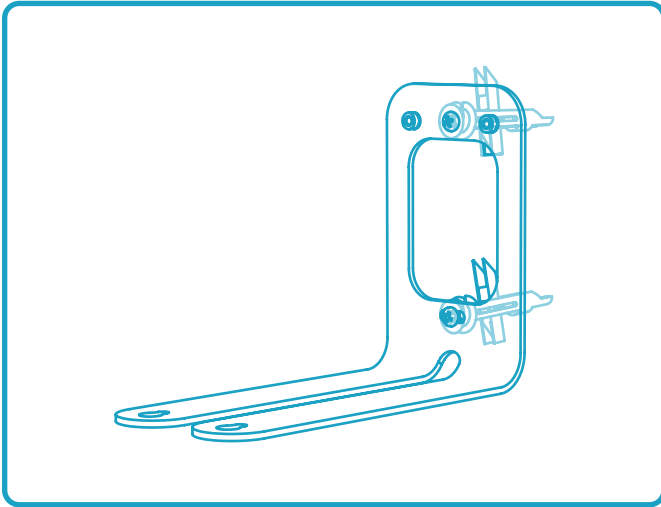

B Gang Box (not included)

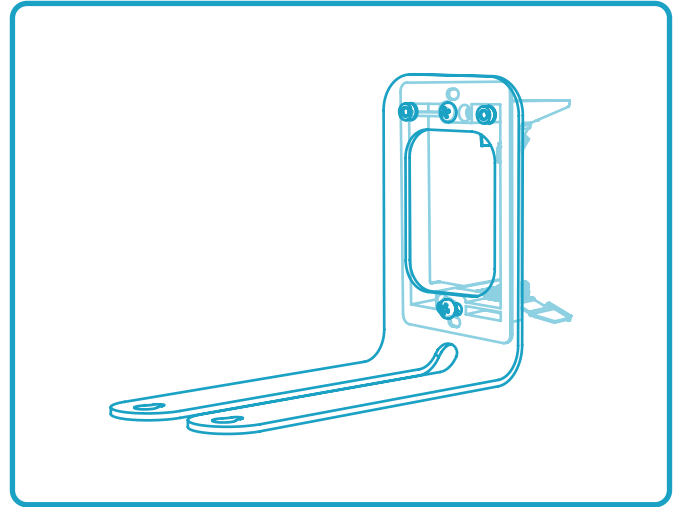

Skip step 4 and 5

STEP 4

Mark wall anchor locations.

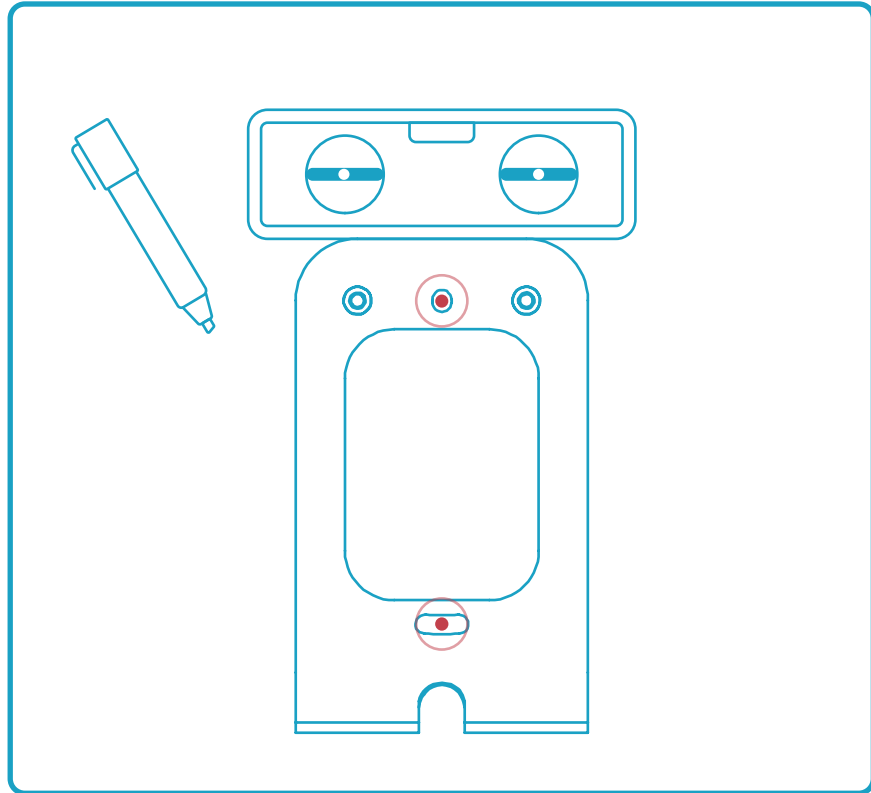

STEP 5

Install wall anchor and drill a 3/4" hole.

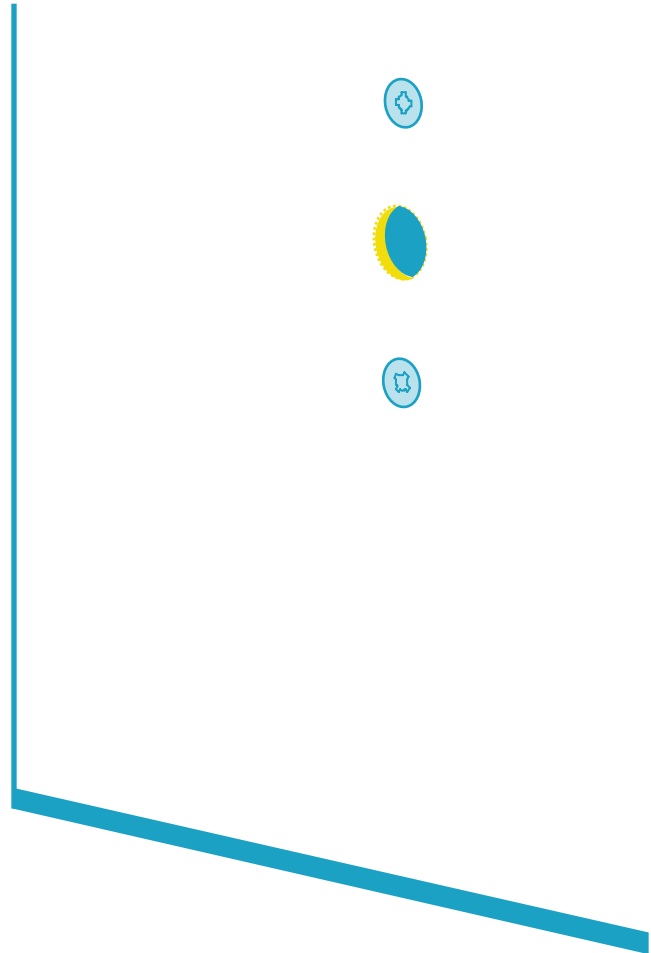
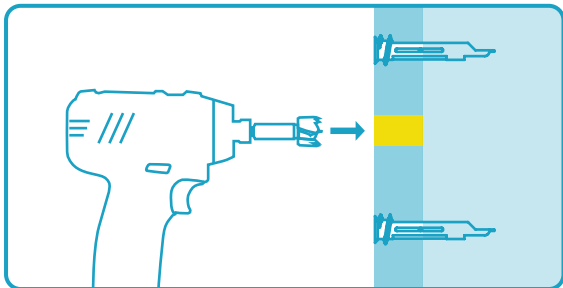
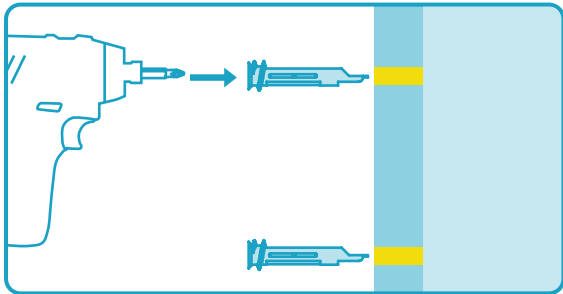

STEP 6

Route cabling, then assemble upper bracket to the lower bracket.

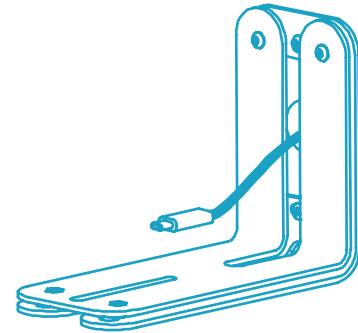
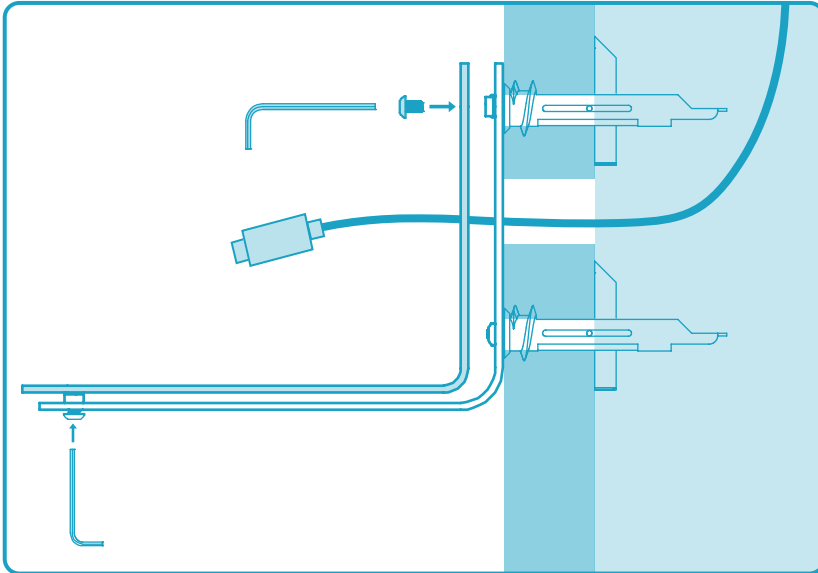

STEP 7

Mount PTZ camera.

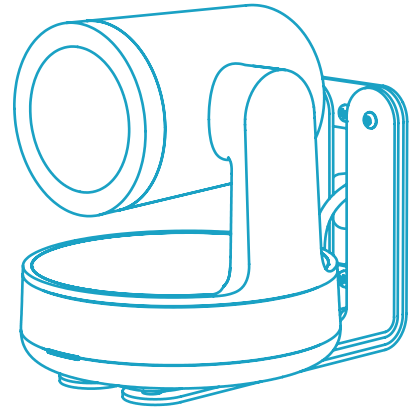
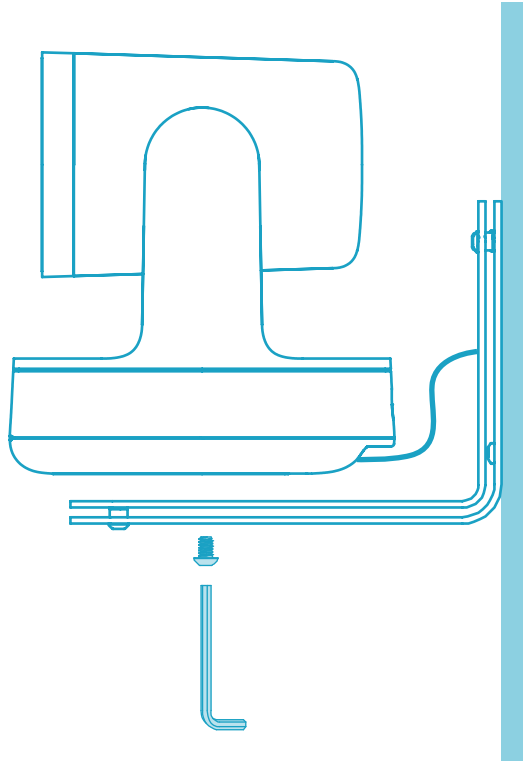

Optional

Tidy cabling.



Organize the cables with the cable tie provided.

